

Angle Grinders/ Sanders

- ST-804R** 100° 4" Heavy Duty Grinder
- ST-8045R** 100° 4-1/2" Heavy Duty Grinder
- ST-805R** 100° 5" Heavy Duty Grinder

*ST-804R // Packing:12PCS/21.2/22.2KGS/2
**ST-8045R, ST-805R // Packing:12PCS/22.5/23.5KGS/2

1.2HP

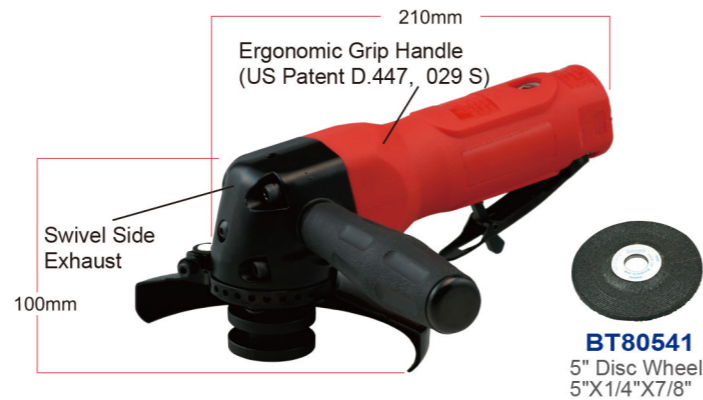
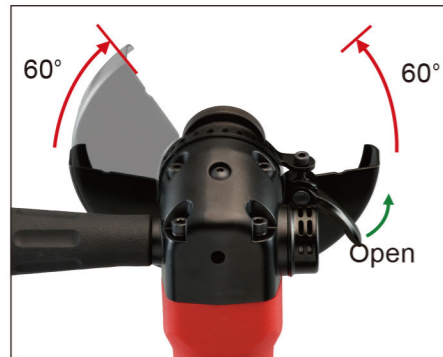

1HP Angle Grinders

- ST-304R** 4" Air Angle Grinder
- ST-3045R** 4-1/2" Air Angle Grinder
- ST-305R** 5" Air Angle Grinder

- Powerful lightweight.
- Bottom exhaust.
- Guard Included.
- Both hands operating.

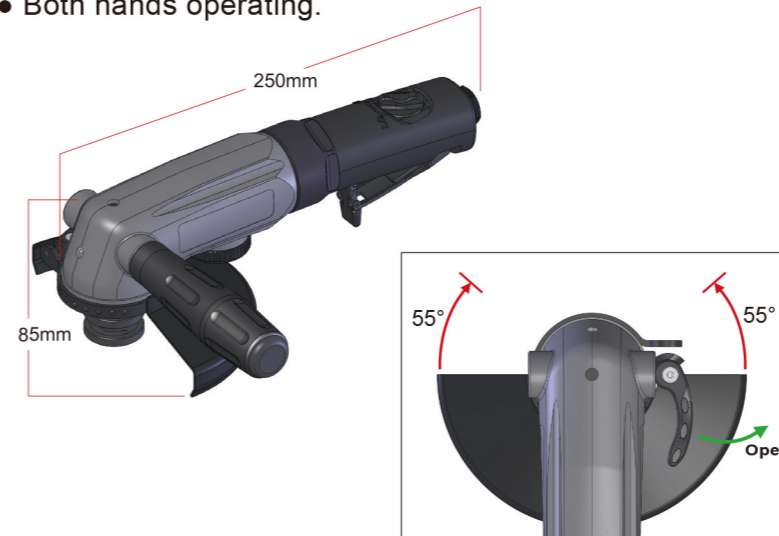

- ST-974** 4" Angle Grinder

- Speed adjustable rotary regulator.
 - Powerful and lightweight.
- *Packing:10PCS/16/16.6KGS/1.2'



- ST-804** 100° 4" Heavy Duty Grinder
- ST-8045** 100° 4-1/2" Heavy Duty Grinder
- ST-805** 100° 5" Heavy Duty Grinder

*ST-804 // Packing:12PCS/21.2/22.2KGS/2'
**ST-8045, ST-805 // Packing:12PCS/22.5/23.5KGS/2'



- ST-704N** 4" Angle Grinder

- Powerful air motor to maintain RPM under heavy load.
 - Removable side handle included.
 - Guard/ wheel flange set included M10*1.5 male threaded spindle.
 - Safety-lock throttle level optional.
- *Packing:10PCS/15.4/16KGS/1.2'



- ST-500** Air Sander

- Specifications as same as ST-805 series.
- *Packing:12PCS/19.3/20.3KGS/2'



- ST-975** Air Sander

- Speed adjustable rotary regulator.
 - Powerful and lightweight.
- *Packing:10PCS/16/16.6KGS/1.2'



Model No.	Spindle Thread	Grinding Wheel	Weight lb/kg	Length in.(mm)	RPM	Air Inlet in.	Min. Hose Size in.(mm)	Avg. Air Cons. (CFM)
ST-704N	3/8"-24, M10x1.5	4"	2.4 (1.1)	7.2(185)	10,000	1/4	3/8(10)	4
ST-804/804R	3/8"-24, M10x1.5	4"	3.1 (1.4)	8.2(210)	10,000	1/4	3/8(10)	3.5
ST-8045/8045R	5/8"-11, M14x2	4-1/2"	3.1 (1.4)	8.2(210)	10,000	1/4	3/8(10)	3.5
ST-805/805R	5/8"-11, M14x2	5"	3.1 (1.4)	8.2(210)	10,000	1/4	3/8(10)	3.5

Model No.	Spindle Thread	Grinding Wheel	Weight lb/kg	Length in.(mm)	RPM	Air Inlet in.	Min. Hose Size in.(mm)	Avg. Air Cons. (CFM)
ST-304R	3/8"-24, M10x1.5	4"	2.7(1.2)	9.8(250)	11,000	1/4	3/8(10)	3.6
ST-3045R	5/8"-11, M14x2	4-1/2"	2.9(1.3)	9.8(250)	11,000	1/4	3/8(10)	3.6
ST-305R	5/8"-11, M14x2	5"	2.9(1.3)	9.8(250)	11,000	1/4	3/8(10)	3.6
ST-500	3/8"-24	4", 5"	3.1 (1.4)	8.2(210)	10,000	1/4	3/8(10)	3.5
ST-974	3/8"-24, M10x1.5	4"	2.6 (1.2)	7.8(200)	11,000	1/4	3/8(10)	4
ST-975	3/8"-24	4", 5"	2.6 (1.2)	7.8(200)	11,000	1/4	3/8(10)	4

1.3HP Angle Grinders

NEW

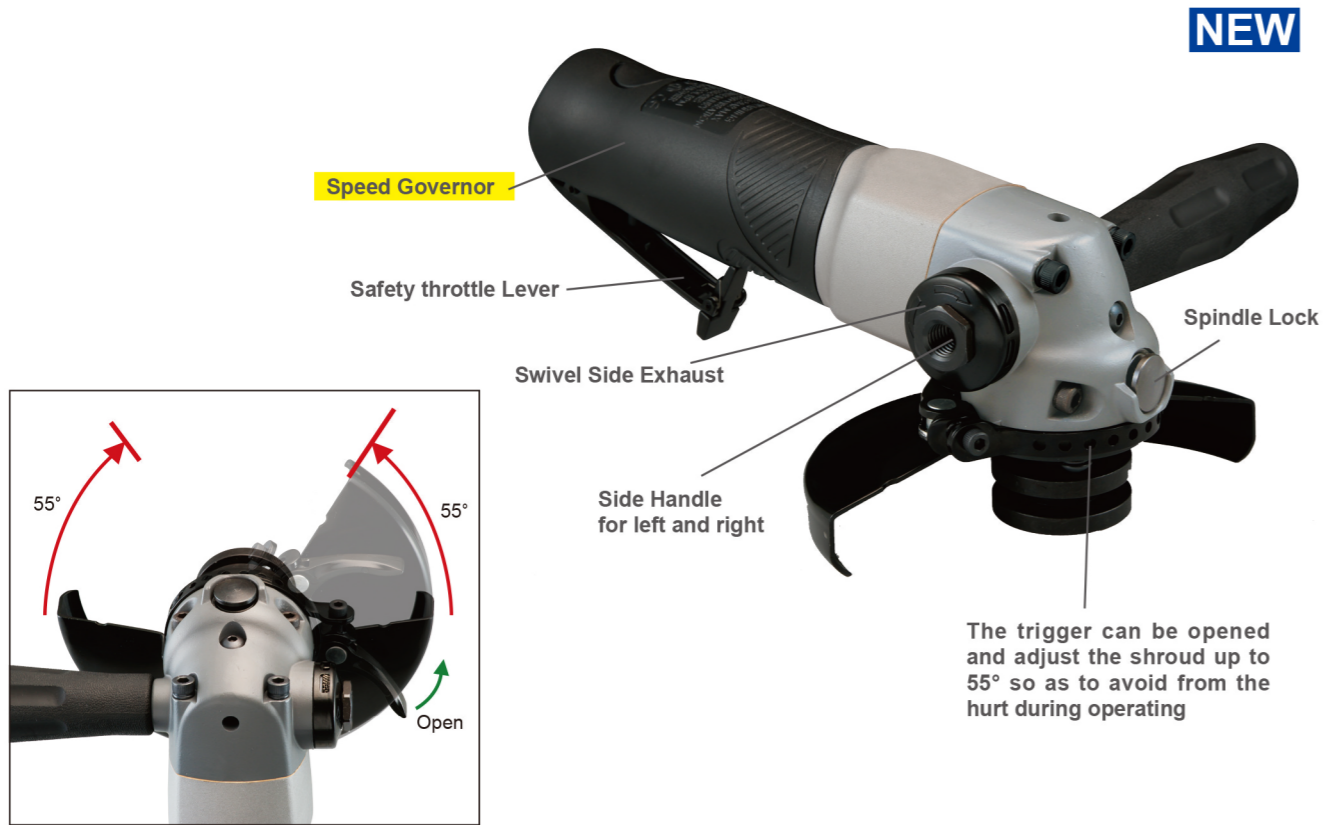

ST-855C
5" H.D. Angle Grinder With Central Vacuum Wheel Guard



- ST-854R** 4" Angle Grinder
- ST-8545R** 4-1/2" Angle Grinder
- ST-855R** 5" Angle Grinder

- 1.3 HP Motor for stall resistance.
- Safety lock-off throttle lever.
- One piece housing reduces maintenance costs.
- Heavy duty air cooled spiral gears and double bearings for durability.
- Ergonomic composite grip for comfort and reduced vibration.
- ANSI compliance wheel guard design.

Best for: Continuous use, heavy duty surface preparation, and material removal.

*Packing : 6PCS/12/13KGS/1.8'



ST-227 (4,000RPM)
Multi-Function Angle Sander / Polisher

*Packing:10PCS/11.2/12.8KGS/0.96'

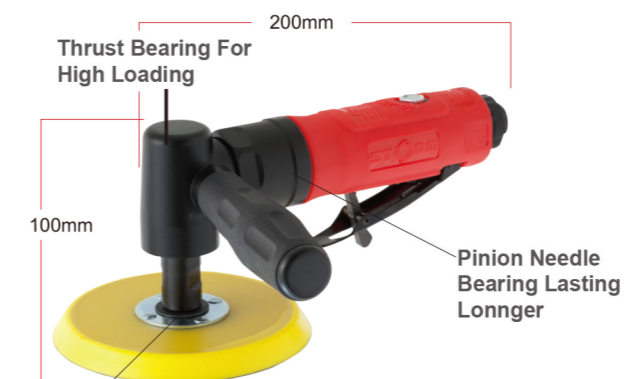

Complete Range of Optional Adaptors

ST-226 (1,800RPM)
Multi-Function Angle Sander / Polisher

*Packing:10PCS/13/13.5KGS/0.96'



Model No.	Grinding Wheel	Spindle Thread	lb/kg	Length	RPM	Air Inlet	Min. Hose Size	Avg. Air Cons.
			Lbs.(Kg)					
ST-854R	4"	3/8"-24 M10x1.5	4(1.8)	9(230)	11,000	1/4	3/8(10)	3.8
ST-8545R	4-1/2"	5/8"-11 M14x2	4(1.8)	9(230)	11,000	1/4	3/8(10)	3.8
ST-855R	5"	5/8"-11 M14x2	4(1.8)	9(230)	11,000	1/4	3/8(10)	3.8

Model No.	Grinding Wheel	Spindle Thread	lb/kg	Length	RPM	Air Inlet	Min. Hose Size	Avg. Air Cons.
			Lbs.(Kg)					
ST-855C	5"	5/8"-11 M14x2	4(1.8)	9(230)	11,000	1/4	3/8(10)	3.8
ST-226	Pad Dia. 5"	5/16"-24	2.2(1)	8(205)	1,800	1/4	3/8(10)	3.5
ST-227	Pad Dia. 5"	5/16"-24	2.2(1)	7.8(200)	4,000	1/4	3/8(10)	3.5

ST-2297 (4,000 RPM)
ST-229725 (2,400 RPM)
0.5HP Angle Sander / Polisher



ST-297 (4,000RPM)
ST-29725 (2,500RPM)
Angle Sander / Polisher

*Packing:10PCS/11.2/12.8KGS/0.96'

NEW



ST-231A (15,000RPM)
ST-231B (12,000RPM)

2" Angle Sander

- Includes ST-231A locking-type pad (3" diameter and 2" diameter).
- The Angle Sander is ideal for all types of sanding on small areas.

*Packing:12PCS/10.3/11.3KGS/0.8'



ST-232
3" Orbital Sander

- Ideal for headlamp, windshield and small area repair and finishing.
- 2.5mm orbital diameter.

*Packing:12PCS/11/12KGS/0.8'



ST-608
Air High Speed Sander

*Packing:20PCS/21/22KGS/1.2'



ST-55011 (11,000RPM)
ST-55008 (8,000RPM)

4-1/2" - 5" Dia. Disc Sanders

- Each model includes ST-55011 Disc Pad Assembly for slotted center-hole abrasive discs.
- Gearless motor for reduced maintenance and downtime.
- Governor-controlled to maintain RPM under heavy load.
- Removable side handle.

*Packing:10PCS/12.5/13.5KGS/0.96'



0.7HP

ST-5526S (2,600RPM)
ST-5540S (4,000RPM)

5" Dia. Disc Sanders

- Includes ST-5526S Locking-Type Pad (5" diameter); pad mounts to tool spindle without adapters.
- Governor speed control maintains RPM under load.
- Gearless for reduced maintenance and down-time.
- Removable side handle.

*Packing:10PCS/14/14.5KGS/1.4'



0.7HP

Model No.	Spindle Thread	Weight lb/kg	Length in.(mm)	RPM	Air Inlet in.	Min. Hose Size in.(mm)	Avg. Air Cons. (CFM)
ST-2297/ ST-229725	5/16"-24	2.2(1)	8.8(225)	4,000 / 2,400	1/4	3/8(10)	3.5
ST-297/ ST-29725	5/16"-24	2.2(1)	8.8(225)	4,000 / 2,400	1/4	3/8(10)	4.1

Model No.	Grinding Wheel	Spindle Thread	Weight lb/kg	Length in.(mm)	RPM	Air Inlet in.	Min. Hose Size in.(mm)	Avg. Air Cons. (CFM)
ST-231A/ ST-231B	2"	5/16"-24	1.5 (0.7)	7(180)	15,000/12,000	1/4	3/8(10)	3.5
ST-608	5"	3/8"-24	2 (0.9)	5.7(145)	16,000	1/4	3/8(10)	5
ST-232	3"	1/4"-20	1.5(0.7)	7.2(185)	15,000	1/4	3/8(10)	3.5
ST-55008	4-1/2", 5"	5/8"-11	2 (0.9)	6.1(155)	8,000	1/4	3/8(10)	0.7
ST-55011	4-1/2", 5"	5/8"-11	2 (0.9)	6.1(155)	11,000	1/4	3/8(10)	0.7
ST-5526S	5"	5/16"-24	2 (0.9)	7.4(190)	2,600	1/4	3/8(10)	4
ST-5540S	5"	5/16"-24	2 (0.9)	7.4(190)	4,000	1/4	3/8(10)	4

- Excellent for roughing body filler, rust removal, and smoothing welds .
- Both hands operating.
- Lightweight for easy handling.
- Outperforms than regular ones.

High Power NEW

ST-871
7" Angle Sander (4,500RPM)

*Packing : 6PCS/14.4/15.4KGS/1.42'



ST-872
7" Angle Polisher (2,500RPM)

*Packing : 6PCS/14.4/15.4KGS/1.42'

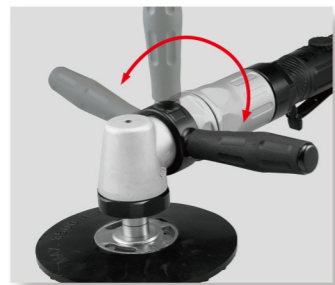

180°Rotational Handle



Spindle Lock



Low noise design



BT871-07W
7" Wool pad



ST77152 (5/8"-11 Thread)
ST77152-1 (M14x2 Thread)
7" Pad Hook-up



ST87158 (5/8"-11 Thread)
ST87158.1 (M14x2 Thread)
7" Plastic Pad



ST870S60 (5/8"-11 Thread)
ST870S60.1 (M14x2 Thread)
7" Rubber Backing Pad

1HP

ST-771
7" Angle Polisher (2,500 RPM)

Benefits

- Powerful motor for productivity
- Maximize operator comfort
- Lightweight with side handle for easy handling
- Excellent for buffing and polishing flat and contoured surfaces

Features

- Heavy-duty angle polisher
- 1.0 hp precision motor
- Built-in air regulator
- High quality alloy steel bevel gears with well hardened and ground
- Delivered with 7" Hook-up polishing pad and with 7" pad



ST-772
7" Angle Sander (4,000 RPM)

Benefits

- Powerful motor for productivity
- Low vibrations and durability
- Lightweight with side handle for easy handling
- Perfect for weld smoothing, paint, rust and stone removal

Features

- Heavy-duty angle sander
- 1.0 hp precision motor
- Built-in air regulator
- High quality alloy steel bevel gears with well hardened and ground
- Delivered with 7" (178 mm) pad
- Muffled rear exhaust



BT871-07W
7" Wool pad



ST77152 (5/8"-11 Thread)
ST77152-1 (M14x2 Thread)
7" Pad Hook-up



ST87158 (5/8"-11 Thread)
ST87158.1 (M14x2 Thread)
7" Plastic Pad



ST870S60 (5/8"-11 Thread)
ST870S60.1 (M14x2 Thread)
7" Rubber Backing Pad

Model No.	Spindle Thread	Weight lb/kg	Length in.(mm)	RPM	Air Inlet in.	Min. Hose Size in.(mm)	Avg. Air Cons. (CFM)
ST-871	M14x2 5/8"-11	5.1 (2.3)	12.9(328)	4,500	1/4	3/8(10)	3.8
ST-872	M14x2 5/8"-11	5.1 (2.3)	12.9(328)	2,500	1/4	3/8(10)	3.8

Model No.	Spindle Thread	Weight lb/kg	Length in.(mm)	RPM	Air Inlet in.	Min. Hose Size in.(mm)	Avg. Air Cons. (CFM)
ST-771	5/8"-11 M14x2	3.9(1.7)	13.6(345)	2,500	1/4	3/8(10)	3.8
ST-772	5/8"-11 M14x2	3.9(1.7)	13.6(345)	4,000	1/4	3/8(10)	3.8